

Crestron **GLPPA-KP**  
Keypad for GLPP  
Installation Guide



**Further Inquiries**

If you cannot locate specific information or have questions after reviewing this guide, please take advantage of Crestron's award winning customer service team by calling Crestron® at 1-888-CRESTRON [1-888-273-7876]. For assistance in your region, please refer to the Crestron Web site ([www.crestron.com](http://www.crestron.com)) for a listing of Crestron worldwide offices.

You can also log onto the online help section of the Crestron Web site ([www.crestron.com/onlinehelp](http://www.crestron.com/onlinehelp)) to ask questions about Crestron products. First-time users will need to establish a user account to fully benefit from all available features.

**Future Updates**

As Crestron improves functions, adds new features and extends the capabilities of the GLPPA-KP units, additional information may be made available as manual updates. These updates are solely electronic and serve as intermediary supplements prior to the release of a complete technical documentation revision.

Check the Crestron Web site periodically for manual update availability and its relevance. Updates are identified as an "Addendum" in the Download column.

**WARNING:** To avoid fire, shock, or death; turn off power at circuit breaker or fuse and test that power is off before wiring!

**NOTES:** Observe the following:

- To be installed and/or used in accordance with appropriate electrical codes and regulations.
- If you are unsure about any part of these instructions, consult a qualified electrician.

**Crestron Electronics, Inc.**  
15 Volvo Drive Rockleigh, NJ 07647  
Tel: 888.CRESTRON  
Fax: 201.767.7576  
[www.crestron.com](http://www.crestron.com)

**Installation Guide - DOC. 7211A**  
**(2031031)**  
**11.11**

Specifications subject to  
change without notice.

This product is Listed to applicable  
UL Standards and requirements by  
Underwriters Laboratories Inc.



**DESCRIPTION**

The GLPPA-KP is an in-wall keypad for Crestron Green Light® Power Pack (GLPP) systems, used to set and recall presets, and turn on and off all loads connected to a GLPP. Installation is made easy thanks to a two wire low-voltage bus which connects the GLPPA-KP and GLPP main unit. Available in black, white and almond, the GLPPA-KP fits almost any décor. Up to two GLPPA-KPs can be connected to a single GLPP system for multi-point control in a room.

**Flexible Configuration**

Two sets of button configurations accompany every GLPPA-KP: a rocker for turning on/off and dimming, and a set of four pre-labeled buttons for ALL ON, ALL OFF, SCENE 1, and SCENE 2 control. Scenes can be adjusted by any user directly right from the keypad.

**Easy Installation**

Two flying leads connect the GLPPA-KP to the GLPP system via a non-polarized low-voltage bus. Use a choice of new or existing high-voltage (class 1) or low-voltage (class 2) wiring for quick installation.

**Specifications**

Specifications for the GLPPA-KP are listed in the following table.

*GLPPA-KP Specifications*

SPECIFICATION	DETAILS
Power Requirements	1 Watt (0.05 Amps @ 24 Volts DC) supplied by GLPP over proprietary two wire bus
Environmental Temperature Humidity	32° F to 104° F (0° C to 40° C) 10 to 90% RH (non-condensing)
Enclosure	Injection molded plastic, one gang mountable in a standard electrical box, requires decorator style faceplate (not supplied)
Dimensions Height Width Depth	4 1/8 in (105 mm) 1 3/4 in (45 mm) 1 13/16 in (46 mm)
Weight	4 oz (50 g)

**GLPPA-KP Dimensions**

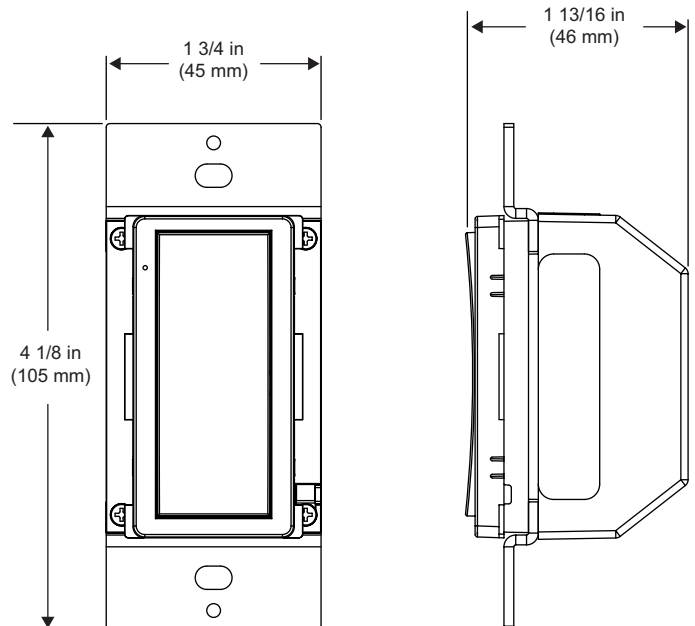
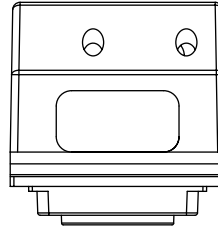

## INSTALLATION

### Wiring

1. Using new or pre-existing wiring connect the two non-polarized white wires with black stripes from the GLPP dimmer or switcher to the two wires on the keypad.
2. If a secondary switch is being used in the room wire the switch in parallel.

### Wiring the GLPPA-KP

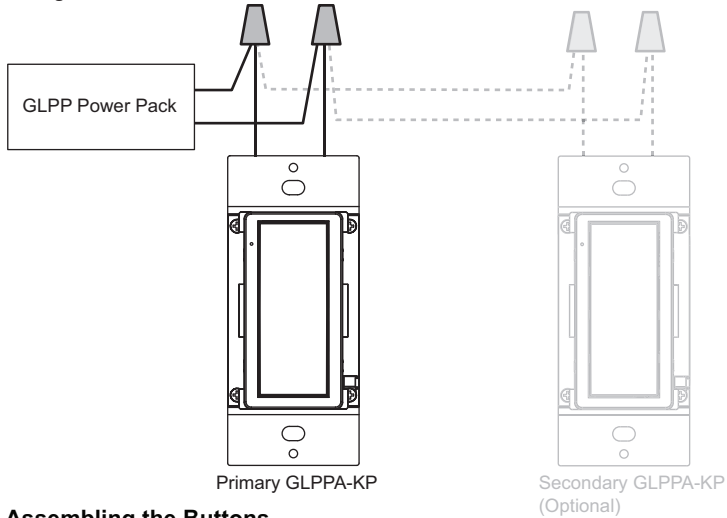

### Assembling the Buttons

The GLPP-KP comes preassembled with a rocker button. If necessary, the rocker can be replaced with the four included buttons. If the rocker is going to be used skip to "Installing into Single Gang Box" in next column, otherwise assemble the keypad as described in the following steps. Refer to the accompanying illustrations.

1. As shown in the following diagram, remove the button assembly by squeezing the sides of the bezel near the bezel snaps.

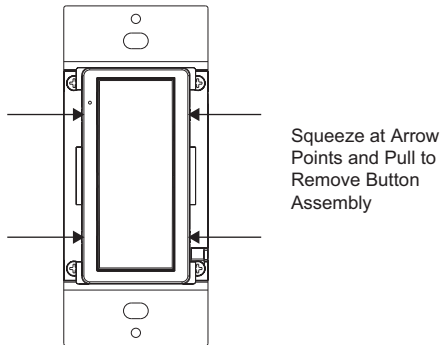

2. Remove the button from the front of the button assembly then insert the new buttons through the front of the bezel and snap them into place. Refer to the following illustration.

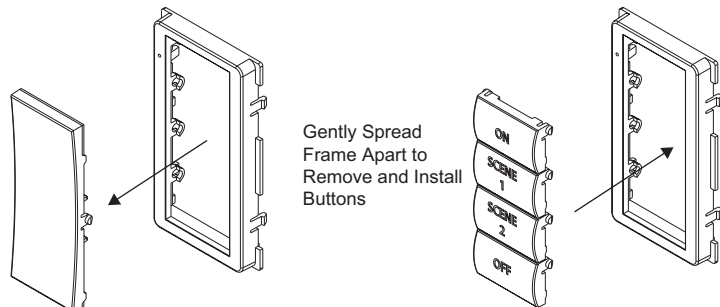

4. Attach button assembly to the device as shown in the following diagram. Ensure that the LED is on the left side.

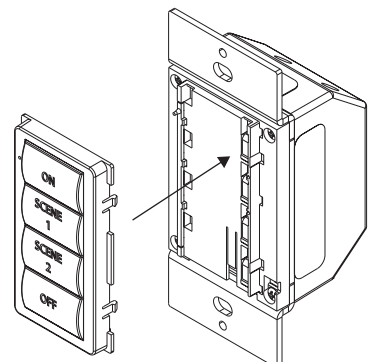

### Installing into Single Gang Box

Follow the procedure below to install the GLPPA-KP into a single gang electrical box. Refer to the illustration that follows for details.

1. Make sure the keypad is oriented properly (note the location of the LED).
2. Place the GLPPA-KP into the electrical box.

**CAUTION:** Excess wire pinched between the keypad and electrical box could short out. Make sure all excess wire is completely inside the electrical box and not between the box and the keypad.

3. Attach it to the electrical box using the included #6-32 x 3/4" screws.

### Installing GLPPA-KP into Single Gang Box

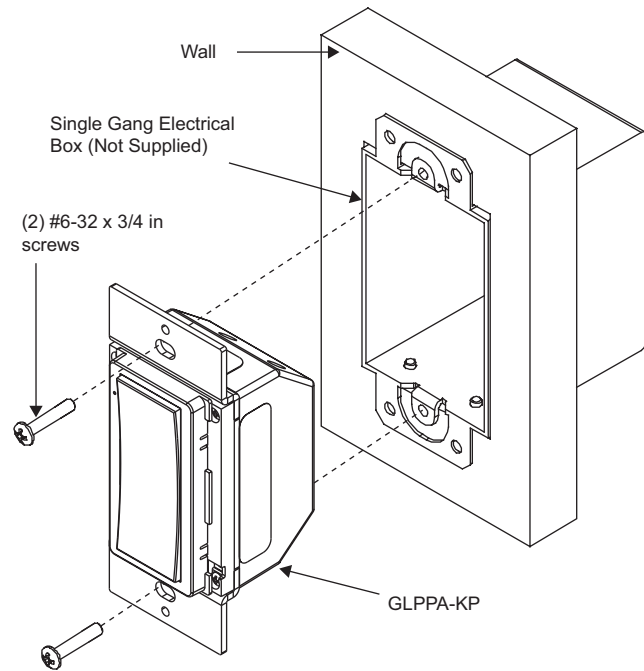

4. Attach the desired decorator style faceplate (not supplied).

## Return and Warranty Policies

### Merchandise Returns / Repair Service

1. No merchandise may be returned for credit, exchange or service without prior authorization from CRESTRON. To obtain warranty service for CRESTRON products, contact an authorized CRESTRON dealer. Only authorized CRESTRON dealers may contact the factory and request an RMA (Return Merchandise Authorization) number. Enclose a note specifying the nature of the problem, name and phone number of contact person, RMA number and return address.
2. Products may be returned for credit, exchange or service with a CRESTRON Return Merchandise Authorization (RMA) number. Authorized returns must be shipped freight prepaid to CRESTRON, 6 Volvo Drive, Rockleigh, N.J. or its authorized subsidiaries, with RMA number clearly marked on the outside of all cartons. Shipments arriving freight collect or without an RMA number shall be subject to refusal. CRESTRON reserves the right in its sole and absolute discretion to charge a 15% restocking fee plus shipping costs on any products returned with an RMA.
3. Return freight charges following repair of items under warranty shall be paid by CRESTRON, shipping by standard ground carrier. In the event repairs are found to be non-warranty, return freight costs shall be paid by the purchaser.

### CRESTRON Limited Warranty

CRESTRON ELECTRONICS, Inc. warrants its products to be free from manufacturing defects in materials and workmanship under normal use for a period of three (3) years from the date of purchase from CRESTRON, with the following exceptions: disk drives and any other moving or rotating mechanical parts, pan/tilt heads and power supplies are covered for a period of one (1) year; touch screen display and overlay components are covered for 90 days; batteries and incandescent lamps are not covered.

This warranty extends to products purchased directly from CRESTRON or an authorized CRESTRON dealer. Purchasers should inquire of the dealer regarding the nature and extent of the dealer's warranty, if any.

CRESTRON shall not be liable to honor the terms of this warranty if the product has been used in any application other than that for which it was intended or if it has been subjected to misuse, accidental damage, modification or improper installation procedures. Furthermore, this warranty does not cover any product that has had the serial number altered, defaced or removed.

This warranty shall be the sole and exclusive remedy to the original purchaser. In no event shall CRESTRON be liable for incidental or consequential damages of any kind (property or economic damages inclusive) arising from the sale or use of this equipment. CRESTRON is not liable for any claim made by a third party or made by the purchaser for a third party.

CRESTRON shall, at its option, repair or replace any product found defective, without charge for parts or labor. Repaired or replaced equipment and parts supplied under this warranty shall be covered only by the unexpired portion of the warranty.

Except as expressly set forth in this warranty, CRESTRON makes no other warranties, expressed or implied, nor authorizes any other party to offer any warranty, including any implied warranties of merchantability or fitness for a particular purpose. Any implied warranties that may be imposed by law are limited to the terms of this limited warranty. This warranty statement supersedes all previous warranties.

Crestron, the Crestron Logo and Crestron Green Light are trademarks or registered trademarks of Crestron Electronics, Inc. in the United States and other countries. UL and the UL logo, are either trademarks or registered trademarks of Underwriters Laboratories, Inc. in the United States and/or other countries. Other trademarks, registered trademarks and trade names may be used in this document to refer to either the entities claiming the marks and names or their products. Crestron disclaims any proprietary interest in the marks and names of others.

©2011 Crestron Electronics, Inc.